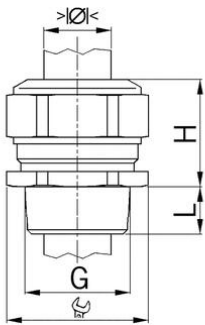

## Cable glands Progress® nickel-plated brass

**Entry thread NPT****Type approval: Progress MS NPT**

- One-piece sealing insert
- not overall length insulated

<b>Article no:</b>	<b>1000.3/4NPT.160</b>
EAN:	7611614116600
Material	Nickel-plated brass
Seal	TPE
Operation temperature	-40°C / +100°C
Protection class	IP 68 (up to 10 bar) / IP 69
Entry thread	NPT 3/4"
NEMA Type rating	4X
Clamping range min.	12.5 mm
Clamping range max.	16.0 mm
Wrench size	30 mm
Dimension H	28 mm
Thread length L	15 mm
UL - clamping range	12.5-16.0 mm
Dispatch	25